

- 1
- 2
- 3
- 4
- 5
- 6
- 7
- 8
- 9
- 10
- 11
- 12
- 13
- 14**
- 15
- 16
- 17
- 18
- 19

TYPE

- Type **F**: flat
 AISI 316 stainless steel **A4**
 Matte shot-blasted finish **GS**

INFORMATION

Mounting plates GN 4490.2 enlarge the contact surface of the mounting blocks of ball catches GN 4490 (see page). This allows mounting blocks to be securely attached to aluminum profiles regardless of the slot width.

ACCESSORIES

- GN 50B:T-Nuts (see page).
- GN 50I:T-Nuts (see page).
- GN 51B:T-Nuts (see page).



Application example

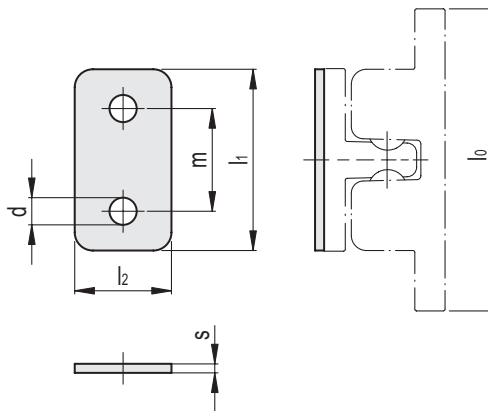
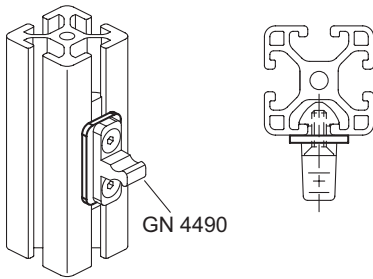

Conversion Table
 1 mm = 0.039 inch

l1	
mm	inch
30	1.17
32.5	1.27
40	1.56

Code	Description	l0 Length of ball catch	l1	l2	d	m	s	For aluminum profiles	⚖
GN.22837	GN 4490.2-A4-50-F-GS	50	30	16	4.5	17	2	20 / 30 / 40 / 45	7
GN.22838	GN 4490.2-A4-68-F-GS	68	32.5	17	4.5	20	2	20 / 30 / 40 / 45	8
GN.22839	GN 4490.2-A4-80-F-GS	80	40	20	5.5	25	2	20 / 30 / 40 / 45	12